

LED Dimming Driver Introduction

The Terncy Joavin driver utilizes ZigBee wireless communication protocol and supports functions such as color temperature adjustment and brightness adjustment, enabling smart lighting control, intelligent scenes, and linked binding.

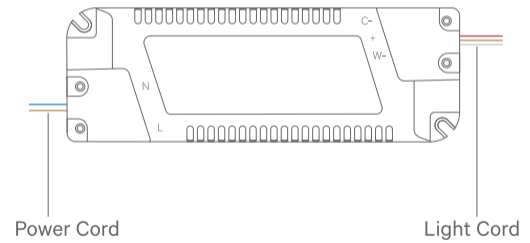

Installation

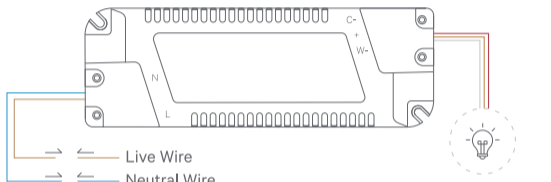

1. Before installation, make sure to disconnect the power to prevent electric shock;
2. Connect the driver with the live wire and neutral wire. Live wire is connected to L, neutral wire is connected to N;
3. Connect the lights with driver.
 - A. When connecting dual color temperature lamps: The cold light line is connected to C, The warm light line is connected to W, and the positive terminal is connected to the + terminal.
 - B. When connecting dimmable lamps: The + is connected to the positive pole, and the negative pole can be connected to either the C terminal or the W terminal.

⚠ Please setup the power and current parameters that match the driver and lamps through Terncy App before use, otherwise it may cause the driver or lamps to work improperly or be damaged.

Installation Notes



1. Use single core wire for connecting the neutral and live wires, and don't use multi-core wire; (Figure 1)
2. The wire used should be 0.75-1.5 millimeters; (Figure 2)
3. The length of the stripped wire should be between 7-8mm; (Figure 2)
4. After completing the connection, the exposed metal parts should not exceed the wiring terminal;(Figure 3)
5. After tightening the screws, it is recommended to test the firmness of the wire by pulling it.

⚠ Please strictly follow the operating guidelines and have the installation done by a professional.

Download and Install App

Download Terncy app from application markets or scan the QR code below. Follow the direction in the app to connect your devices properly.



Add ZigBee Mode Device

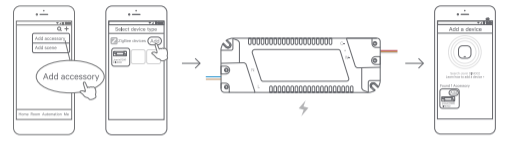

1. Launch Terncy app and log in;
2. Go to the "Add Device" page and select "Add ZigBee Device";
3. Connect the device to power;
4. After about 10 seconds, the app will display the new device found. Follow the on-screen instructions to configure power and current parameters.(Recommended for Professional User Configuration)

ZigBee Mode Indicator Light Explanation

A ZigBee mode driver that has not yet joined the network will automatically attempt to join the network every 30 seconds. If successfully joined, the light will flash slowly. Otherwise, it will flash quickly.
 * If the device is not automatically discovered, please follow the instructions on page 7 or 8 to reset the device.

Reset to Factory Default by Power On/Off

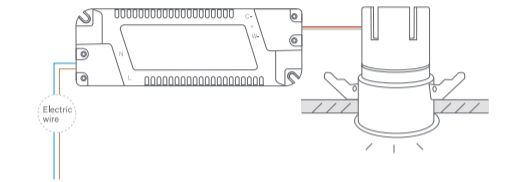

1. Power off and on the switch driver six times in a row (after each power on, the light will turn on and then off, and after each power off, keep it off for at least 7 seconds before powering on again). The light will start slow flashing;
2. The network settings of the driver will be cleared, and you can now re-add them.



Terncy WeChat Account

Contact Us

Online Service: <https://www.xiaoyan.io/service>

Service Call: 400-920-2823

E-mail: support@xiaoyan.io

Shanghai Xiaoyan Technology Co., Ltd.

Room 502, Building E, No.666, Shengxia Road,

Shanghai, China

Reset to Factory Default by Knob switch

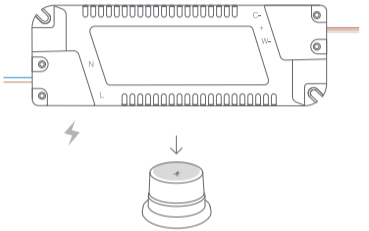

1. Place the knob near the driver to be reset;
2. Quickly press the knob button 6 times, and for the 6th time, press and hold it for 5 seconds until the light starts flashing;
3. Keep holding the button for 5 seconds until the light starts flashing rapidly;
4. The networking information of the drive will be cleared, and it can be re-added.

Specifications

Product Name	Joavin Smart Dimming Driver	
Product Model	DIM002	DIM004
Product Size	132x45x24mm	
Working Voltage	110-240V~ 50/60Hz	
Output Voltage	12~36V \equiv	21~39V \equiv
Operating Temperature	-10~50°C	
Working Humidity	10~85%	
Rated Power	12W	24W
Product Weight	81g	100g
Executive Standard	GB7000.1, GB7000.22, GB/T 17743	

Dos & Don'ts

1. Do not submerge or clean the product;
2. Please keep the product away from fire sources, high temperatures, and other extreme environments.

Note

Xiaoyan Tech Co., Ltd reserves the right to update the content in the manual. Please refer to the latest version for the most accurate information.

Warranty Card

Xiaoyan's after-sales service includes:

Xiaoyan Tech shall remove any physical defects inherent in the device which are listed on the warranty card, free of charge, by replacing (at the sole discretion of Xiaoyan Tech) the defective device within the period of 15 days from the date of reception by the consumer, and by repairing the defective components of the device within the period of 24 months from the date of reception by the consumer.

* The warranties may be varied in different countries and regions.

The Warranty Applies to:

1. Surface damages resulting from mishandling during transport or defects inherent in material or structure of the products;
2. Failure of the buttons or indicator lights;
3. Failure of wireless communication.

The Warranty Does Not Apply:

1. When the warranty period expired;
2. To damages resulting from repairing and introducing alterations by unauthorized persons;
3. To damages caused by using accessories not recommended by the manufacturer;
4. To damages resulting from other irresistible causes.



Joavin

Dual Color Temperature
Smart Dimming Driver Manual

